

# USER MANUAL



**CYC  
LOOP**

# CONTENT

1. Thank You for Purchasing Cycloop!
2. Before You Start
3. Getting Started
4. Where to Install Cycloop
5. How Cycloop Works
  - 5.1 Armed Mode
  - 5.2 Alarm Mode
  - 5.3 Exiting Alarm Mode
  - 5.4 Snooze Mode
  - 5.5 Regular Status Updates
6. Testing an Alarm on Cycloop
7. How to Charge Cycloop Battery and Key Fob Battery Replacement
8. Restoring Default Settings
9. How to Switch On and Off Cycloop
10. LED Indications
11. Updating Firmware
12. Technical Specifications
13. Additional Information

# THANK YOU FOR PURCHASING CYCLOOP!

Thank You for purchasing Cycloop! We will do our best to help you secure your property. If you have any issues, please contact our Support team via the app Help section (fastest) or send an email to [\*\*support@cyclooptracker.com\*\*](mailto:support@cyclooptracker.com)

You can also visit our Help Center at [\*\*https://support.cyclooptracker.com\*\*](https://support.cyclooptracker.com) for more information.

# WHAT'S IN THE BOX:

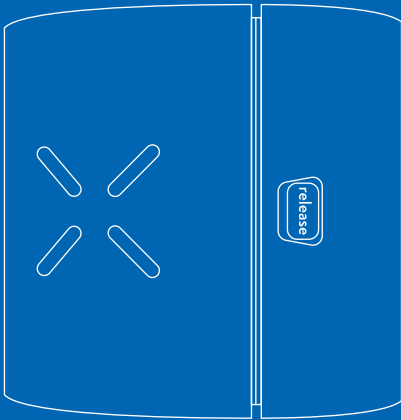

1 X  
CYCLOOP

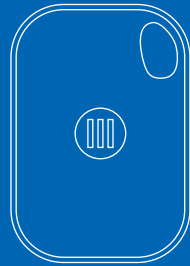

1 X  
KEY FOB

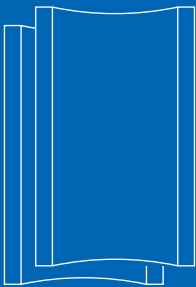

2 X  
SIZING RUBBERS



4 X  
SCREWS



1 X  
HEX KEY

# ***BEFORE YOU START***



Cycloop can be used with iOS 14 or Android 8.0 phones and all subsequent operating systems. Android phones must have access to the Google play store.

Your smartphone must also have Bluetooth 4.0+ (BLE) functionality, as the connection between your phone and Cycloop uses this technology.

## HOW DOES THE KEY FOB WORK?

Cycloop comes with a Key Fob which works on a proximity basis to prevent the tracker from alarming when you move your own bicycle. We recommend keeping it with the owner (not anywhere inside or on the bicycle) at all times. Why? If you keep it on your bike and it gets stolen - the alarm will not start since Cycloop will see the Key Fob nearby.

Depending on your bicycle you may have keys to either unlock a lock, or turn on an electric bike. Most users would naturally keep the Key Fob with such keys, but we must warn you if your bicycle is stolen along with your keys and Key Fob together, then the previously described situation will happen where the tracker is not able to alarm because it detects the nearby Key Fob.

That is why we recommend keeping the Key Fob in a jacket, pants pocket, backpack or bag - somewhere on your person.

### THINGS TO KEEP IN MIND:

- Your Key Fob can connect to Cycloop up to a maximum range of 50m/~150ft in an open area without interference, range will typically be less due to walls/objects causing interference.
- Each Cycloop can be paired with up to 3 Key Fobs.
- Each Key Fob can be paired with an unlimited number of Cycloop trackers.
- Cycloop searches for satellites to deliver precise GPS locations but GPS signals are poor inside places such as: basements, garages, lifts, underground car parks, concrete buildings, and tunnels. In such cases Cycloop sends approximate locations using Cell ID technology (cellular tower triangulation), or uses WLS wireless location services.
- Each time Cycloop enters Alarm mode and sends locations, the battery drains faster so avoid false alarms to save battery life.

# GETTING STARTED

## STEP 1

Charging your Cycloop's Battery for the first time.

1

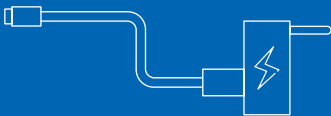

Get a USB-C charging cable and adapter (not provided with Cycloop)

2



Remove Cycloop from the packaging and take the larger part of cycloop which has the 2 'X' LED's

3

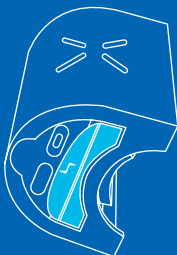

Find the USB-C charging port located under the waterproof rubber covering (you will need to lift up the rubber)

4

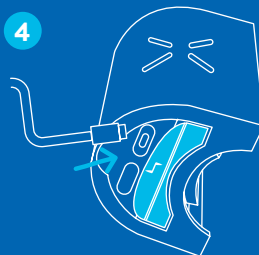

Plug your USB-C charging cable into the charging port. LED's will pulse RED, the number of LED's determines battery charge (1=25%, 2=50%, 3=75%, 4=100%)

# GETTING STARTED

## STEP 1

5



Wait till the LED sequence displays all 4 lights ON (100%) indicating full battery, then the lights will turn off by themselves once it is fully charged - you can do the App setup in STEP 2 while waiting for full charge

6

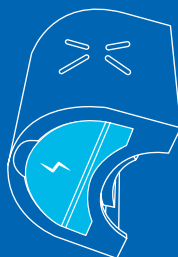

After Cycloop is fully charged, remove the cable, and



### **IMPORTANT:**

make sure the rubber covering is securely back in place to prevent water entering



# GETTING STARTED

## STEP 2

Prepare the Key Fob

**FIRST MAKE SURE THE BATTERY TAB IS REMOVED FROM THE KEY FOB**

1

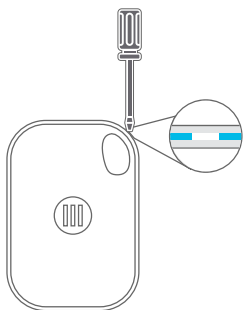

Insert a small flat screwdriver into the special hole and lift.

2

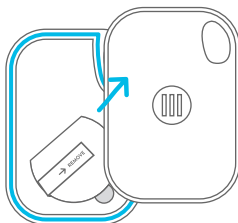

Separate the two black pieces.

3

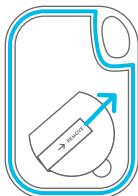

Remove the battery tab.

4

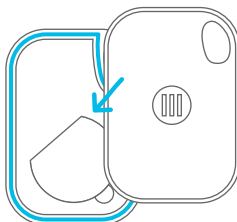

Realign the two sides and firmly close till you hear a 'click' sound.

# GETTING STARTED

## STEP 3

Monimoto Application Setup (Cycloop uses the Monimoto App).  
Search “Monimoto” in App Store or Google Play Store:



Download the Monimoto App and install it on your smartphone.  
Minimum OS requirements are iOS 14 and Android 8



Run the Monimoto App and follow the on-screen step-by-step instructions that will guide you through the setup process. Android users, please make sure both Bluetooth and location services are turned on.



### IMPORTANT:

All the pairings are done only through the App.  
Please do not try to pair your Cycloop or the Key Fob directly through your Phone's Bluetooth Settings because the App might be unable to finish setup.

Once the setup process has been completed you should receive an SMS from your device. Be sure to add that number to your contacts with an appropriate name so you recognize it immediately in case of alarm when the device calls you.

# WHERE TO INSTALL CYCLOOP

Cycloop is intended to be placed on your bicycle in order to track it down in case of theft. After completing the App setup process, now it's time to attach it to your bike. Because there are so many different types of bicycles and frames it may take some experimentation to find a good location.

Cycloop is intended to be attached to one of your bicycle frame's tubes. The Cycloop clamp has 2 insertable sizing rubbers giving a range of either 25-30mm (Tube size 1) or 30-37mm (Tube size 2) diameter length for attaching to your bicycle's frame. **Keep in mind it will not be possible to securely attach Cycloop to bicycle tubes with a diameter larger than 37mm. Allowed tube shapes are: circular, circular cut, oval.** If it is not one of these shapes then it might not be possible to securely attach Cycloop.



## IMPORTANT:

When installing make sure the side with the rubber covering and USB-C charging port is facing down towards the ground to prevent water entering from above.

# WHERE TO INSTALL CYCLOOP

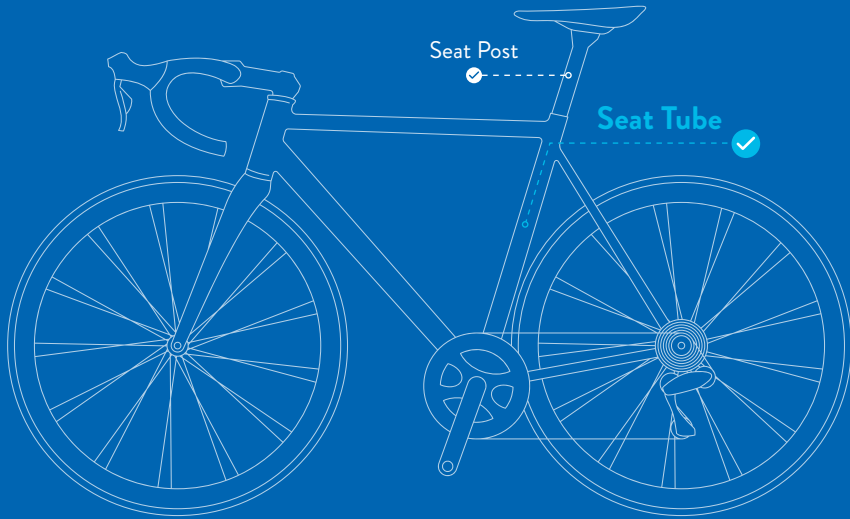

## RECOMMENDED INSTALLATION LOCATIONS

**Seat Tube** - this is the primary location for Cycloop because on most bicycles the seat tube is enclosed by other tubes of the frame.

- Cycloop needs a minimum clearance distance of 45mm between the seat tube and any other bicycle parts, especially the tire.
- **WARNING: If minimum clearance distance is not met and Cycloop comes loose and slides into the tire, it can cause an accident.**

# *WHERE TO INSTALL CYCLOOP*

- Check clearance distance by sliding Cycloop along all positions on the tube making sure it doesn't come into contact with any other parts.
- You can also try to turn Cycloop so the electronics side of the device faces away from the tire/other parts.
- Make sure Cycloop is properly secured to the tube to prevent it from coming loose and sliding on the tube.
- Make sure no cables/wires are on the tube you attach Cycloop to, otherwise it will not be properly secured
- Be very careful attaching Cycloop to a Carbon bike frame, it can damage the frame if too much pressure is applied.

**Alternative locations:** Seat Post or anywhere which will allow the Cycloop clamp to have a secure attachment to the frame.



## **IMPORTANT:**

If installing Cycloop on a seatpost which has a quick-release clamp make sure to replace the clamp with regular screws to prevent thieves from easily removing the seatpost and Cycloop.

# HOW CYCLOOP WORKS

Cycloop has 2 main modes - **Armed Mode** and **Alarm Mode**.

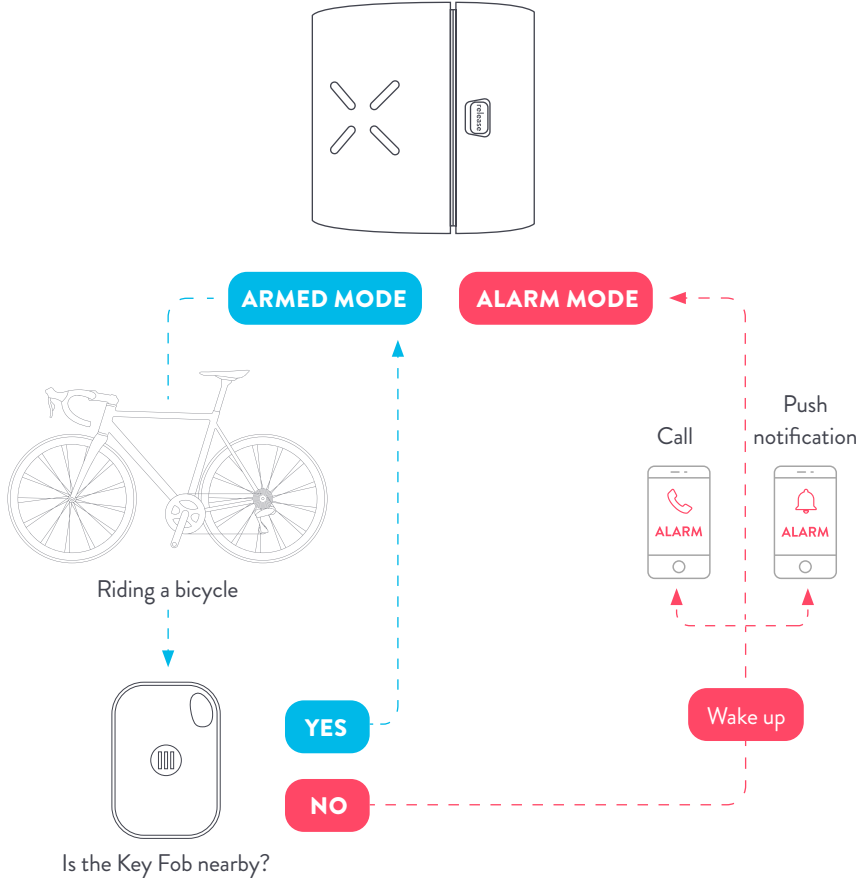



## IMPORTANT:

The App uses internet connections as its primary way to communicate with the device so it's highly recommended to keep mobile data or Wi-Fi turned ON on your Phone at all times.

Please note **Cycloop is not a 'real time' tracking device.** It does not have a constant connection with the LTE-M network and is not constantly sending its location. Cycloop connects to the LTE-M network and **sends locations only when Alarm mode is triggered.** This helps to considerably save battery life.

## ARMED MODE

Once you go through the App setup and successfully configure your device – you should see a green “ARMED” sign. This means Cycloop is ready to detect any type of movement and notify you if the Key Fob is not around. You do not need to activate Cycloop in any other way.



### RIDING A BICYCLE

Cycloop remains in ARMED mode and does not alarm if the owner has a Key Fob while riding the bike.

## ALARM MODE

When Cycloop senses any type of motion, movement or vibration, the first thing it does is a Key Fob check. If the Key Fob is not found, the device will enter Alarm mode.

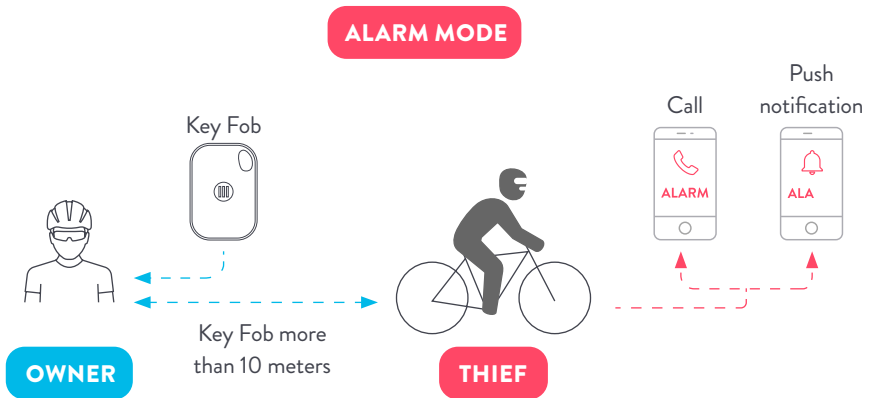

**When in alarm mode Cycloop first calls the owner's number. It will call ONCE and after that you will start receiving push notifications to the Monimoto app.** You will see a GPS location in the Events Tab if precise location data is received or if GPS is not available then an approximate location using Cell ID (LTE-M Cell tower triangulation), or WLS wireless location if there are Wi-Fi routers nearby.

By default you will get updates every 5-10 minutes (or every 2-3 minutes if Live Tracking is enabled) in Alarm mode while the movement continues. Once your Cycloop-equipped bike has stopped moving you will be updated with a last location after 30 minutes and Alarm mode will be canceled. If movement resumes, the alarm will start again.





## THESE TWO TIMELINES ILLUSTRATE HOW CYCLOOP BEHAVES TIME-WISE:

### Cycloop Alarm Process

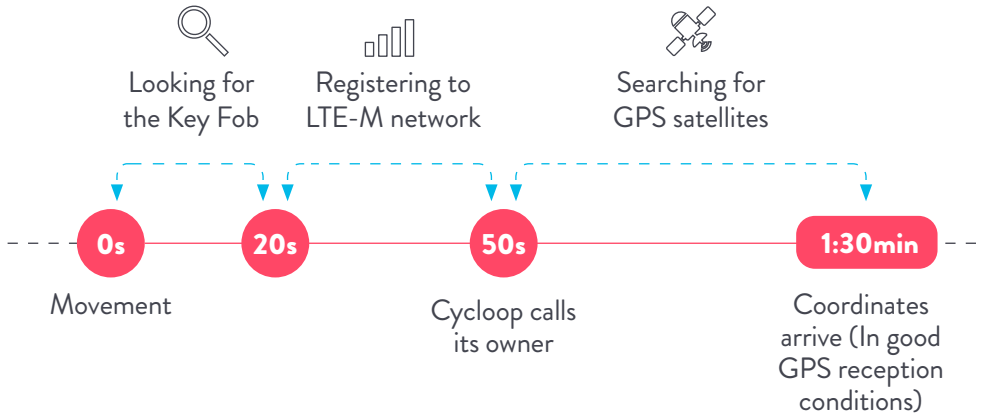

### How Cycloop Sends Locations after Alarm Starts

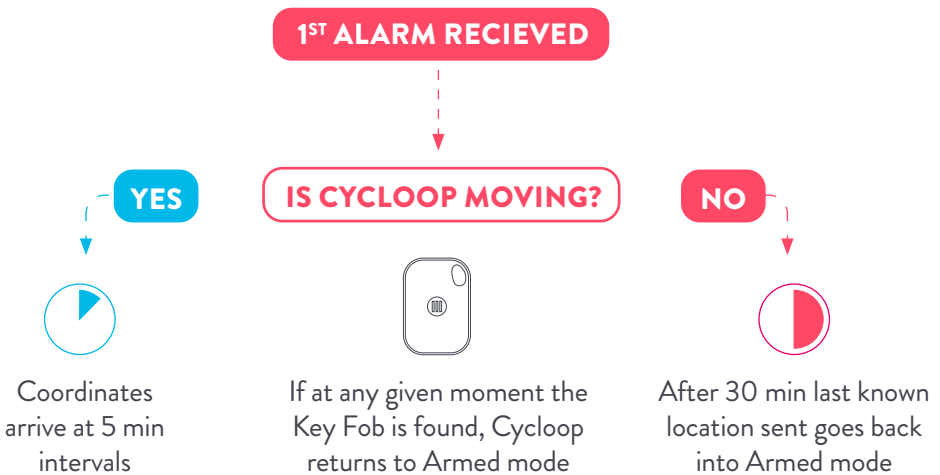

# EXITING ALARM MODE

There are 3 ways an alarm is canceled and returns Cycloop back to Armed mode:

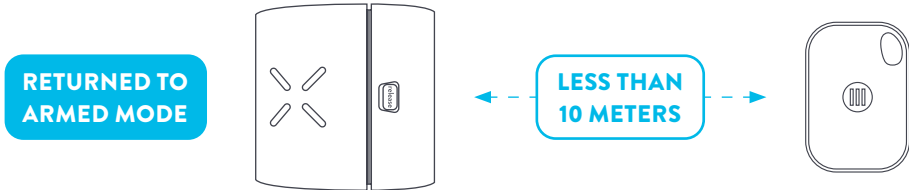

- **Exit Alarm with Key Fob.** Once the Key Fob is detected within bluetooth range typically 15m/~50ft (Maximum 50m / ~150ft in an open area without obstacles), Cycloop will automatically return to Armed mode.
- **Disarm by App.** You can turn off Alarm mode by app only when your phone is within Bluetooth signal range. If you open the app, go to Settings Tab - Connect button (establishing bluetooth connection) it will return to Armed mode and cancel Alarm mode.
- **No motion detected for 30 minutes** - Cycloop will send one last location and then cancel the alarm.

# SNOOZE MODE

**Snooze mode can only be activated immediately after an alarm is triggered**, a button will appear on the Home Tab - **Put into Snooze Mode** - this button will disappear a few minutes after the alarm has been triggered and afterwards it's no longer possible to put into Snooze mode. Snooze can be useful if you've gone for a ride but forgot the Key Fob at home and want to stop receiving alerts and save battery life. Or if you gave your bike to a friend but forgot to give them the Key Fob.

- You can set Cycloop to Snooze for **1-24 hours** using the app.
- This action will disarm Cycloop and you will not be able to bring it back to Armed mode until the selected snooze period ends.

- It is not possible to remotely wake up a Cycloop which has been successfully snoozed.
- When the snooze period ends it will return to Armed mode automatically, no action is required.
- The only way to end Snooze mode before the snooze period has finished is to be close to your tracker with your phone and in the App - Settings - push the Connect button (phone/tracker in bluetooth range) which will cancel Snooze and return Cycloop back to Armed mode.

## **REGULAR STATUS UPDATES**

Cycloop regularly performs a battery check and updates status to your phone. If Cycloop encounters LTE-M network issues or batteries are drained and regular updates cannot be performed you will be notified in the app.

The frequency of Regular Updates can be set using the Monimoto app in Settings. We recommend sticking to the default setting (once every 24 hours) and receiving regular updates everyday. This will assure you the device is working properly, and will notify you when the battery is empty. By default regular updates are not set to send a location. That can be adjusted from the Settings menu, however we do not encourage you to have locations sent with regular updates since it drains battery significantly to send locations.

# ***TESTING AN ALARM ON CYCLOOP***

1. Leave your Key Fob at home.
2. Switch off Bluetooth on your phone and close the Monimoto Application.
3. Take your Cycloop-equipped bicycle for a test ride outdoors.
4. In approximately 1 minute you should receive a call from Cycloop and soon after push notifications should arrive to the App.
5. Open the App and check whether it is showing the precise GPS, WLS based or approximate Cell ID (LTE-M network based location).
6. If you received precise GPS locations – use one of the exit alarm mode methods to disarm the alarm.
7. If you received an approximate location please re-install your Cycloop in a different spot on your bicycle or try again. Note: very tall buildings can reduce GPS signal strength to the point of not being able to obtain precise locations.
8. Repeat the test ride until you get precise GPS locations.

# ***HOW TO CHARGE THE CYCLOOP BATTERY***

1

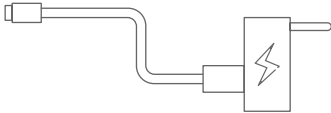

Get a USB-C charging cable and adapter (not provided with Cycloop).

2

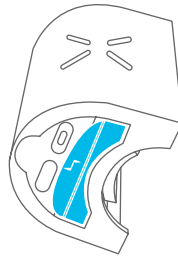

Find the larger part of Cycloop with the 2 X LED's, and locate the USB-C charging port under the waterproof rubber covering (you will need to lift up the rubber).

# HOW TO CHARGE THE CYCLOOP BATTERY

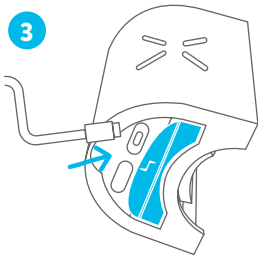

3 Plug your USB-C charging cable into the charging port.

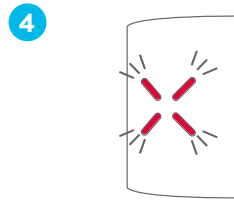

4 Wait till all 4 LED's display SOLID RED indicating full battery.

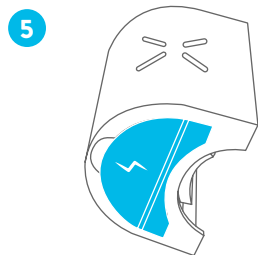

## IMPORTANT:

Remove the cable, and make sure the rubber covering is securely back in place to prevent water/dust entering.

# ***KEY FOB BATTERY REPLACEMENT***

1

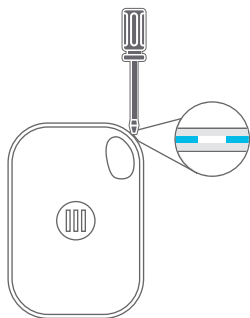

Insert a small flat screwdriver into the special hole and lift.

2

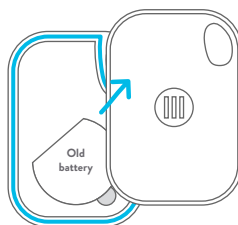

Separate the two black pieces.

3

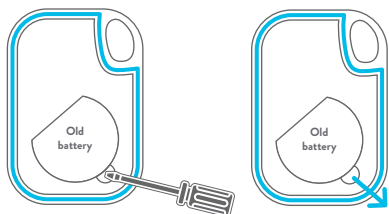

Remove the battery by lifting it up slightly using a flat screwdriver and properly dispose of the used battery.

# ***KEY FOB BATTERY REPLACEMENT***

4

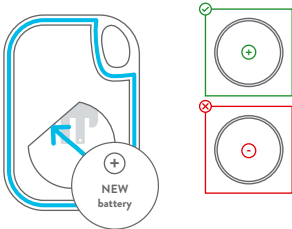

Put a new CR2032 battery into the enclosure. The positive (+) side of the battery faces up and the negative (-) side faces down. There should be a brief LED light indicating the battery is properly seated.

5

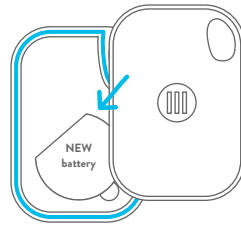

Realign the two sides and firmly close till you hear a 'click' sound.



# ***RESTORING DEFAULT SETTINGS***

1. Find the reset button as shown in this graphic (if Cycloop is installed on your bicycle you will need to remove it to access the reset button).

Protip: the included hex key can be used to push the reset button

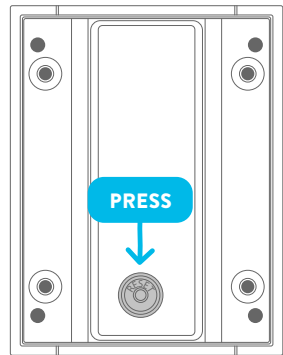

2. Press and Hold the Reset button for at least 12 seconds -> 1 LED on the side with the little 'lock' symbol will turn SOLID BLUE - then it will briefly turn OFF (**DO NOT use anything sharp to press the reset button, otherwise waterproofing could be damaged**)
3. Hold the button until the LED displays **FLASHING BLUE** - then release the reset button - it will briefly display SOLID BLUE and then turn OFF.
4. Then LED's should flash RED sequentially clockwise followed by all 4 LED's gradually pulsing brighter and dimmer (indicating successful reset to Default Settings).

# ***HOW TO SWITCH ON AND OFF CYCLOOP***

Once your Cycloop has been successfully set up it will always be ON unless you specifically switch it OFF or it runs out of batteries.



## **IMPORTANT:**

Once a device has been switched OFF, the only way to switch ON the device is by plugging in the powered USB-C charging cable to the charging port. It is impossible to switch ON the device from the App or by pushing the reset button, only plugging in the charging cable can switch ON the device.

## **To SWITCH OFF your device.**

1. Find the Reset button (same button as in Restoring Default Settings).
2. Press and Hold the Reset button for 3 seconds -> 1 LED on the side with the little 'lock' symbol will turn SOLID BLUE then it will turn OFF. **Release the button once the blue LED has turned off to avoid accidentally resetting the device!**
3. Device is now turned OFF.

# ***HOW TO SWITCH ON AND OFF CYCLOOP***

## **To SWITCH ON your device.**

1. Get a USB-C charging cable and adapter (not provided with Cycloop).
2. Find the larger part of Cycloop with the 2 X LED's, and locate the USB-C charging port under the waterproof rubber covering (you will need to lift up the rubber).
3. Plug your USB-C charging cable into the charging port.
4. The device should switch ON and LED's will display the battery charging indication.

# LED INDICATIONS

LED indication	Description
All RED LED's are ON, and gradually pulsing brighter and dimmer.	Device is currently in Default/Factory Settings or was successfully reset to default.
LED's VERY QUICKLY flash RED sequentially in a clockwise motion one at a time.	Motion is being detected by the device. It will display this LED indication whether the device is in alarm mode or not, as long as there is movement detected.
1-4 LED's gradually pulse RED, the number of LED's ON indicates battery charge level	Cycloop battery is charging. 1 light is pulsing then 25% battery charged 2 lights pulsing then 50% battery charged 3 lights pulsing then 75% battery charged 4 lights are SOLID ON indicates 100% battery is fully charged.
1 BLUE LED is blinking	Device is registering to the cellular network.
All RED LED's and 1 BLUE LED (on the side with little lock symbol) will briefly flash at the SAME TIME once every 3 seconds.	Device Firmware Update (DFU Mode) if you see this indication then please contact our Customer Support using an in-App message or via email to support@cyclooptacker.com

# ***UPDATING FIRMWARE***

In most cases the Firmware will automatically update by itself and you will not need to do anything. But it's also possible to see a pop-up appear in the App saying "New Firmware is Available" to install you can go to App - Settings Tab - Connect button (phone/tracker in bluetooth range) and there should appear an "Update Firmware" button.

# ***TECHNICAL SPECIFICATIONS***

## **DEVICE DIMENSIONS**

Height 79 mm / 3.11 inches, Max Width 62 mm / 2.44 inches, Max Length 90mm / 3.54 inches

## **DEVICE WEIGHT**

249g / 8.78 oz. with Tube size 1, 238g / 8.4 oz. with Tube size 2

## **CLAMP DIAMETER RANGE**

25 - 30 mm / 1 - 1.18 inches with Tube size 1, 30 - 37 mm / 1.18 - 1.45 inches with Tube size 2

## **BATTERIES**

Cycloop: 3.7V Li-Polymer (1930 mAh) rechargeable

Key Fob: 3V Lithium CR2032 (1 battery)

## **BATTERY OPERATION TIME**

Cycloop: up to 12 months without side LEDs OR up to 3 months with side LEDs ON for average 2 hour daily drive\*

Key Fob: up to 12 months

## **DUST AND WATER**

### **RESISTANCE RATING**

Cycloop: IP65, Key Fob: IP65

## **RANGE OF OPERATING TEMPERATURES**

0°C to 60°C (32°F to 140°F)

Battery will only charge above 10°C / 50°F ambient temperature.

10°C to 15°C (50°F to 59°C) slow charging available (half of normal charging speed), 15°C to 45°C (59°F to 113°F) normal charging speed

\*The operation time will vary depending on usage of the device. Each full charge will give a maximum 1500 locations with LED sidelights on for a daily 2 hr. Ride.

## **APPLICATION IOS/ANDROID OS REQUIREMENTS**

Minimum iOS 14 or Android 8, Androids must have Google Play store

## **ESIM (NON-REMOVABLE)**

Yes

## **ESIM COVERAGE**

EU, UK, USA

## **CELLULAR MODULE**

SARA-R510M8S, Ublox (from Switzerland)

## **NETWORK CONNECTIVITY BANDS**

LTE CAT-M1 modem

Bands 1, 2, 3, 4, 8, 12, 18, 19, 20, 28

## **LTE POWER CLASS (DBM)**

23

## **BLUETOOTH VERSION**

LE

## **GPS LOCK TIME**

Hot start: <2 sec@open sky); Cold start: <45 sec

## **ASSISTED GPS**

Yes

## **SATELLITE NAVIGATION**

GLONASS, GPS

## **INDOOR NAVIGATION**

Wi-Fi Positioning System (WPS) included in future over-the-air firmware update.

## **USB**

C-type

## **ACCELEROMETER**

3 Axis

## **WARRANTY**

Valid for 24 months from purchase date

# ***ADDITIONAL INFORMATION***

## **TERMS OF USE**

The following terms and conditions govern the use of the Cycloop device and contains important information on limitations regarding the product's use and function, as well as information on the limitations of the manufacturer's liability. Please carefully read these terms and conditions for download, installation, display and use of the mobile application ("Application") before you download, install, display or use the Application.

## **TECHNICAL SUPPORT**

In order to ensure continuous and proper operation of the Cycloop device and uninterrupted service, it is the responsibility of the User to make sure that: (i) the product is properly installed, and (ii) there is constant internet or LTE connection and electrical supply (low battery must be recharged in time). If you experience difficulty during the installation or subsequent use of the system, you may contact "Monimoto UAB" distributor or dealer in your country region. For more information see [monimoto.com](http://monimoto.com)

## **SAFETY INSTRUCTIONS**

Please read and follow these safety guidelines in order to maintain safety of operators and people around:

- DO NOT use the system where it can cause potential danger and interfere with other devices – such as medical devices.
- DO NOT use the system in a hazardous environment.
- DO NOT expose the system to high humidity, chemical environment or mechanical impact.
- DO NOT attempt to repair the system yourself – any repairs must be carried out by fully qualified personnel only.
- DO NOT try to disassemble Cycloop.
- NEVER install or carry out maintenance during stormy weather.
- To switch the system OFF, press and hold the reset button for 12 seconds.



## **INSTALLATION SAFETY**

- Cycloop needs a minimum clearance distance of 45mm between the seat tube and any other bicycle parts especially the tire.
- Check clearance distance by sliding Cycloop along all positions on the tube making sure it doesn't come into contact with any other parts
- You can also try to turn Cycloop so the electronics side of the device faces away from the tire/other parts.
- Make sure Cycloop is properly secured to the tube, prevent it from coming loose and sliding on the tube.
- Make sure no wires are on the tube you attach Cycloop to, otherwise it will not be properly secured.
- If minimum clearance distance is not met and Cycloop comes loose and slides into the tire, it can cause an accident.
- Be very careful attaching Cycloop to a Carbon bike frame, it can damage the frame if too much pressure is applied.

CE or FCC related Radiofrequency radiation exposure information: this equipment complies with radiation exposure limits prescribed for an uncontrolled environment for fixed and mobile use conditions. This equipment should be installed and operated with a minimum distance of 20 cm between the radiator and the body of the user or nearby persons. Make sure the device is more than 20cm away from a person's body.

## **WARRANTY PROCEDURES**

To obtain warranty service, you may return a defective system to your original point of purchase, or the authorized "Monimoto UAB" dealer or the distributor from which you purchased the Cycloop product. In order to request warranty service, the purchaser is required to provide proof of purchase.

## **MANUFACTURER WARRANTY**

"Monimoto UAB" warrants this system only to the original purchaser and only in case of defective workmanship and materials under normal use of the system for a period of twenty four (24) months from the date of shipment by the "Monimoto UAB" (Warranty Period). Warranty obligations do not cover expendable materials (power elements and/or batteries), holders and enclosures. The warranty remains valid only if the system is used as intended, following all guidelines outlined in this manual and in according to the operating conditions specified. The warranty is void if the system has been disassembled or exposed to mechanical impact, chemicals, high humidity, fluids, corrosive and hazardous environments or force majeure factors.

If a hardware defect arises and a valid claim is received within the Warranty Period, at its own discretion, “Monimoto UAB” will either (a) repair a hardware defect at no charge, using new or refurbished replacement parts, or (b) exchange the product with a product that is new or which has been manufactured from new or serviceable used parts and is at least functionally equivalent to the original product, or (c) refund the purchase price of the product.

## **LIMITED LIABILITY**

The buyer must agree that the system will reduce the risk of theft, burglary or other dangers but does not provide a guarantee against such events. “Monimoto UAB” will not assume any responsibility regarding personal or property, or revenue loss while using the system. “Monimoto UAB” is not affiliated with any of the Internet providers, therefore, it shall not be responsible for the quality of Internet service. “Monimoto UAB” shall also assume no liability due to direct or indirect damage or loss, as well as unreceived income when using the system, including cases, when the damages arise due to the above mentioned risks, when due to breakdown or malfunction the user is not informed in a timely manner about a risk which has arisen. In any case, the liability of “Monimoto UAB”, as much as it is allowed by the laws in force, shall not exceed the price of acquisition of the product.

## **CONSUMER PROTECTION LAWS**

CONSUMER PROTECTION LAWS FOR CONSUMERS WHO ARE COVERED BY CONSUMER PROTECTION LAWS OR REGULATIONS IN THEIR COUNTRY OF PURCHASE OR, IF DIFFERENT, THEIR COUNTRY OF RESIDENCE, THE BENEFITS CONFERRED BY THIS WARRANTY ARE IN ADDITION TO ALL RIGHTS AND REMEDIES CONVEYED BY SUCH CONSUMER PROTECTION LAWS AND REGULATIONS.

This warranty grants upon you specific legal rights, and you may also have other rights that vary by country, state or province.

## DISPOSAL AND RECYCLING INFORMATION



The WEEE (Waste Electrical and Electronic Equipment) symbol on this product (see left) means it must not be disposed of in household waste. To prevent possible harm to human health and/or the environment, you must dispose of this product in an approved and environmentally safe recycling facility. For further information contact your system supplier, or your local waste authority.

**Copyright © “Monimoto UAB”, 2023. All rights reserved.**



It is strictly forbidden to copy and distribute the information contained in this document or to pass thereof to a third party without an a priori written authorization obtained from “Monimoto UAB”. “Monimoto UAB” reserves the right to update or modify this document and/or related products without an a priori warning.

“Monimoto UAB” hereby declares that the Cycloop smart alarm for bicycles is in compliance with essential requirements and other relevant provisions of the Directive 2014/53/EU. The full text of the EU declaration of conformity is available at the following internet address: [monimoto.com/eu/declaration-of-conformity](http://monimoto.com/eu/declaration-of-conformity).

Monimoto UAB, Sauletekio al. 15,  
Vilnius, Lithuania LT-10224,  
[support@cyclooptracker.com](mailto:support@cyclooptracker.com)

#### **WARNING!**

- This product contains a rechargeable lithium battery.
- If the battery compartment does not close securely, stop using the product and keep it away from children.
- Disposal of a battery into fire or a hot oven, or mechanically crushing or cutting a battery can result in an explosion.
- Leaving a battery in an extremely high or low temperature surrounding environment that can result in an explosion or the leakage of flammable liquid or gas.

#### **Approved batteries for Keyfob model KEY4:**

Non rechargeable 3V Lithium CR2032: Energizer CR2032, Panasonic CR2032, Varta CR2032, GP CR2032, Jauch CR2032, Renata CR2032, EEMB CR2032

## FCC COMPLIANCE INFORMATION

THIS DEVICE COMPLIES WITH PART 15 OF THE FCC RULES.



Operation is subject to the following two conditions: (1) This device may not cause harmful interference, and (2) This device must accept any interference received, including interference that may cause undesired operation.

**Note:** This equipment has been tested and found to comply with the limits for a Class B digital device, pursuant to part 15 of the FCC Rules. These limits are designed to provide reasonable protection against harmful interference in a residential installation. This equipment generates, uses, and can radiate radio frequency energy and, if not installed and used in accordance with the instructions, may cause harmful interference to radio communications. However, there is no guarantee that interference will not occur in a particular installation. If this equipment does cause harmful interference to radio or television reception, which can be determined by turning the equipment off and on, the user is encouraged to try to correct the interference by one or more of the following measures:

- Reorient or relocate the receiving antenna.
- Increase the separation between the equipment and receiver.
- Connect the equipment into an outlet on a circuit different from that to which the receiver is connected.
- Consult the dealer or an experienced radio/TV technician for help.

Modifications not expressly approved by the manufacturer may void the user's authority to operate the equipment under FCC rules.

